

DLA Splined Threaded Insert

Aluminium · Large flange · Splined · Open end
M4 - M10

Features

- Designed to provide load bearing threads in thin sheet materials
- Splined body provides increased torque-to-turn resistance over conventional non-splined inserts
- Reduced tail end diameter offers ease of hole entry
- Large flange head provides a load bearing surface and reinforces the hole to prevent push-out

Material

- Aluminium, clear protective coating

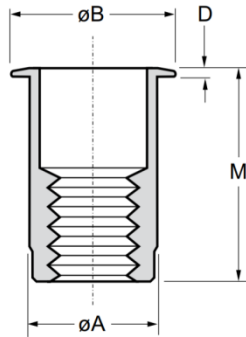

Before Placement

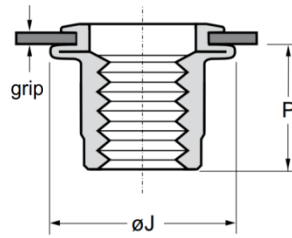

After Placement

Part No.	Thread Size	Grip Range		Hole Size	ϕA	ϕB	D	ϕJ	M	P
		min.	max.	+0.15/-0	max.	± 0.25	± 0.08	max.	± 0.38	max.
DLA-470-2.0	M4 x 0.7 6H	0.5	2.0	6.75	6.75	9.91	0.76	9.91	10.67	7.75
DLA-470-3.3		2.0	3.3						11.94	
DLA-580-3.3	M5 x 0.8 6H	0.5	3.3	7.60	7.55	10.54	0.76	11.43	12.07	8.00
DLA-580-5.7		3.3	5.7						14.86	
DLA-610-4.2	M6 x 1.0 6H	0.7	4.2	10.00	9.90	12.70	0.89	13.97	14.73	9.65
DLA-610-6.6		4.2	6.6						17.27	
DLA-8125-3.8	M8 x 1.25 6H	0.7	3.8	13.50	13.45	17.40	0.89	13.97	17.53	11.94
DLA-8125-7.9		3.8	7.9						20.45	
DLA-1015-3.8	M10 x 1.5 6H	0.7	3.8	13.50	13.45	17.40	0.89	13.97	17.53	11.94
DLA-1015-7.9		3.8	7.9						20.45	



Can't find what you are looking for?

We can provide unique and customized solutions.
Contact your nearest [Gripwell](#) team for assistance!